

## OUTSIDE SNAP RING (OSR) STYLE

G1	D1	G2	D2	OE Manufacturer	OE Series	Converts		Greasable	Spicer Part #	Notes
Over Caps	Inside Bearing Cap Diameter	Over Caps	Outside Bearing Cap Diameter			From This Series	To This Series Part	Y=Yes N=No		
1.732	0.811	1.732	0.811	Spicer	44-B			N	050576000	
1.850	0.732	1.850	0.732	Italcardano	47-B			Y	050560000	45° Zerk is located in center of cross
1.909	0.748	1.909	0.748	Spicer	0400SG			N	5-3256X	
2.046	0.750	2.046	0.750	Italcardano	U-30			Y	050910000	90° Zerk is located in center of cross
2.126	0.866	2.126	0.866	Bondoli Pavesi	Series 1			Y	5-3200X	
2.165	0.787	2.165	0.787		Kubota			Y	5-3258-1X	
2.165	0.866	2.165	0.866	Walterscheid	2100			Y	040116*	040116 was replaced by 5-3233X
2.150	0.866	2.150	0.866	Walterscheid	2100			Y	5-3233X	
2.409	0.938	2.409	0.938	Spicer	1100-SG			Y	5-102X*	
2.411	0.938	2.411	0.938	Spicer	61-B or 1100			Y	050701000	
2.411	0.938	2.411	0.938	Italcardano	1100			Y	5-111X*	5-111X was replaced by 5-101X
2.411	0.938	2.411	0.938	Spicer	1100			N	5-101X	
2.438	1.062	2.438	1.062	Spicer	1210			N	5-526X*	5-526X was replaced by 5-443X; has metal back seals
2.438	1.062	2.438	1.062	Spicer	1210			N	5-547X*	5-547X was replaced by 5-443X; has spacer in bearing cap; has metal back seals
2.438	1.062	2.438	1.062	Spicer	1210			Y	5-443X	Lube fitting in bearing cap
2.438	1.062	2.438	1.062	Spicer	1210			Y	5-554X*	Lube fitting in bearing cap; has metal back seals
2.438	1.062	2.438	1.062	Spicer	1210			N	5-736X*	
2.456	1.062	2.456	1.062	Spicer	1210WJ			N	5-3215X	
2.498	0.984	2.498	0.984	Dodge Colt	Dodge			Y	5-1503X	
2.648	1.063	2.648	1.063		Saturn			Y	5-3241X	
2.679	1.125	2.679	1.125	Rockwell	L14N/1240			Y	5-129X	
2.755	1.024	2.755	1.024		Suzuki			Y	5-3257X	
2.764	1.063	2.764	1.063	Bondoli Pavesi	Series 3			Y	5-3232X	
2.931	0.882	2.931	0.882	Rockwell	1FR-AG			Y	5-264X	4-round knurled caps; no bearings in bearing cap
2.933	1.063	2.933	1.063	Walterscheid	2300			Y	044444*	
2.937	1.063	2.937	1.063	Bondoli Pavesi	Series 4			Y	5-3204X	
2.938	1.063	2.938	1.063	Spicer	1300			Y	5-4X*	5-4X was replaced by 5-3214X
2.937	1.062	2.937	1.062	Spicer	1300			Y	5-3214X	
2.939	1.062	2.939	1.062	Spicer	75-B			Y	050585000	
2.993	1.260	2.993	1.260	Italcardano	2400			Y	312410*	312410 was replaced by 5-3235X
2.992	1.260	2.992	1.260	Walterscheid	2400			Y	5-3235X	
3.000	0.985	3.000	0.985		Chrysler/ Mitsubishi			Y	5-3217X	
3.059	1.123	3.059	1.123		Toyota			Y	5-3224X	
3.207	1.250	3.207	1.250	Rockwell	35N/1340			Y	5-243X	
3.219	1.062	3.219	1.062	Spicer	1310			N	5-785X*	5-785X was replaced by 5-1310X; Spicer Life Series
3.219	1.062	3.219	1.062	Spicer	1310/SPL22			N	SPL22-1X*	SPL22-1X was replaced by 5-1310X

\* Part has been discontinued

† Part is available until supply is exhausted

‡ Not sold separately

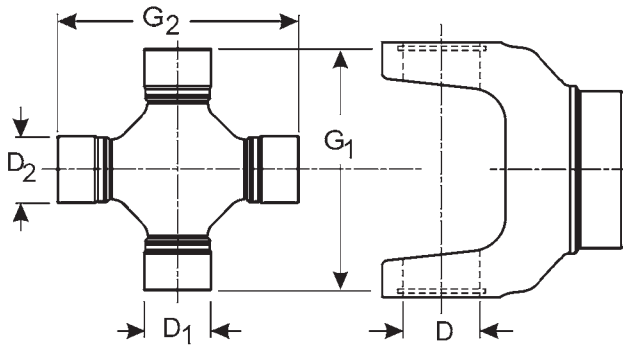
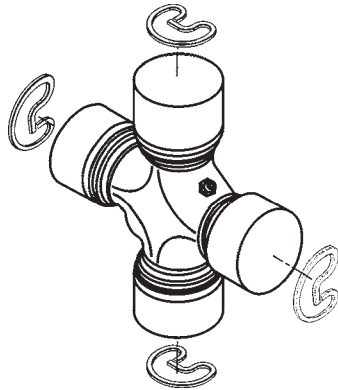

## OUTSIDE SNAP RING (OSR) STYLE (CONTINUED)

G1	D1	G2	D2	OE Manufacturer	OE Series	Converts		Greasable	Spicer Part #	Notes
Over Caps	Inside Bearing Cap Diameter	Over Caps	Outside Bearing Cap Diameter			From This Series	To This Series Part	Y=Yes N=No		
3.219	1.062	3.219	1.062	Spicer	1310/SPL22			N	5-1310X	
3.219	1.062	3.219	1.062	Spicer	1310			Y	5-278X*	5-278X was replaced by 5-153X; flush lube fitting in cross
3.219	1.062	3.219	1.062	Spicer	1310			Y	5-419X†	5-419X will be replaced by 5-153X when supply is exhausted; has metal back seals
3.219	1.062	3.219	1.062	Spicer	1310			Y	5-477X*	5-477X was replaced by 5-153X; has black seals
3.219	1.062	3.219	1.062	Spicer	1310			Y	5-511X*	5-511X was replaced by 5-153X; has long grease Zerk
3.219	1.062	3.219	1.062	Spicer	1310			Y	5-153X	
3.219	1.062	3.219	1.062	Spicer	1310			N	5-611-1X*	Includes various thickness snap rings
3.219	1.062	3.219	1.062	Spicer	1310			N	5-786X*	5-786X was replaced by 5-3613X; coated bearing caps; Spicer Life Series
3.219	1.062	3.219	1.062	Spicer	1310/SPL22			N	SPL22-2X*	SPL22-2X was replaced by 5-3613X; coated bearing caps
3.219	1.062	3.219	1.062	Spicer	1310			N	5-3613X	Coated bearing caps; Spicer Life Series
3.219	1.062	3.219	1.062	Spicer	1310			Y	5-255X*	5-255X was replaced by 5-1310-1X; has metal back seals
3.219	1.062	3.219	1.062	Spicer	1310			Y	5-810X†	5-810X will be replaced by 5-1310-1X when supply is exhausted; lube fitting in bearing cap; Spicer Life Series
3.219	1.062	3.219	1.062	Spicer	1310-CV			Y	5-433-1X*	5-433-1X was replaced by 5-1310-1X; lube fitting in bearing cap
3.219	1.062	3.219	1.062	Spicer	SPL22			Y	SPL22-7X*	SPL22-7X was replaced by 5-1310-1X; Spicer Life Series
3.219	1.062	3.219	1.062	Spicer	1310/SPL22			Y	5-1310-1X	Lube fitting in bearing cap
3.219	1.062	3.219	1.125	Spicer	1310SPEC			Y	5-719X*	
3.219	1.062	3.219	1.125	Spicer	1310SPEC			N	5-787X*	5-787X was replaced by 5-7439X; Spicer Life Series
3.219	1.062	3.219	1.125	Spicer	1310SPEC			Y	5-1201X*	5-1201X was replaced by 5-7439X
3.219	1.062	3.219	1.125	Spicer	1310SPEC/ SPL22	S55	SPL22	N	SPL22-3X*	SPL22-3X was replaced by 5-7439X
3.219	1.062	3.219	1.125	Spicer	S55/1310	S55	1310	N	5-7439X	
3.219	1.062	3.625	1.062	Spicer	1310/1330	1310	1330	Y	5-134X	
3.219	1.062	3.625	1.188	Spicer	1310/1350	1310	1350	Y	5-460X	
3.268	1.181	3.268	1.181		ZF			N	5-3262X	
3.496	1.417	3.496	1.417	Walterscheid	Series 2500			Y	5-3237X	
3.503	1.417	3.503	1.417	Walterscheid	2500			Y	312209*	312209 was replaced by 5-3234X
3.150	1.189	3.150	1.189	Bondiolli Pavesi	Series 5			Y	5-3234X	
3.607	1.066	3.607	1.066	Visteon	1330			Y	5-3253X	
3.612	1.188	3.612	1.188	AAM	AAM 1355			N	5-3208X	
3.622	1.181	3.622	1.181	Walterscheid	W220			Y	041662*	041662 was replaced by 5-3236X
3.622	1.189	3.622	1.189	Bondiolli Pavesi	Series 6			Y	5-3236X	

\* Part has been discontinued

† Part is available until supply is exhausted

‡ Not sold separately

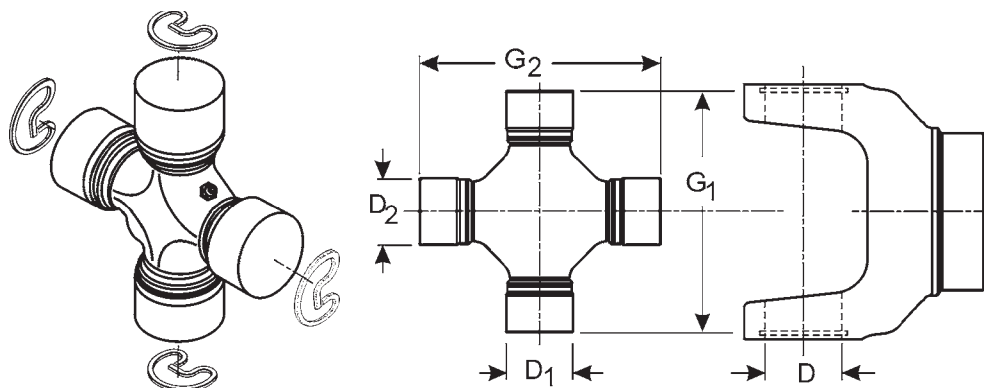

## OUTSIDE SNAP RING (OSR) STYLE (CONTINUED)

G1	D1	G2	D2	OE Manufacturer	OE Series	Converts		Greasable	Spicer Part #	Notes
Over Caps	Inside Bearing Cap Diameter	Over Caps	Outside Bearing Cap Diameter			From This Series	To This Series Part	Y=Yes N=No		
3.625	1.062	3.625	1.062	Spicer	1330			Y	5-1203X	
3.625	1.062	3.625	1.062	Spicer	1330			Y	5-273X*	5-273X was replaced by 5-213X; has metal back seals
3.625	1.062	3.625	1.062	Spicer	1330			Y	5-213X	
3.625	1.062	3.625	1.062	Spicer	1330			N	5-791X*	5-791X was replaced by 5-3614X; coated bearing caps; Spicer Life Series
3.625	1.062	3.625	1.062	Spicer	1330/SPL25			N	SPL25-2X*	SPL25-2X was replaced by 5-3614X; coated bearing caps
3.625	1.062	3.625	1.062	Spicer	1330/SPL25			N	5-3614X	Coated bearing caps; Spicer Life Series
3.625	1.062	3.625	1.062	Spicer	1330			N	5-618X*	5-618X was replaced by 5-1330X
3.625	1.062	3.625	1.062	Spicer	1330			N	5-790X*	5-790X was replaced by 5-1330X; Spicer Life Series
3.625	1.062	3.625	1.062	Spicer	SPL25/1330			Y	5-812X*	5-812X was replaced by 5-1330-1X; Spicer Life Series
3.625	1.062	3.625	1.062	Spicer	SPL25			N	5001919*	5001919 was replaced by 5-1330-1X; lube fitting in bearing cap
3.625	1.062	3.625	1.062	Spicer	1330/SPL25			N	SPL25-1X*	SPL25-1X was replaced by 5-1330X
3.625	1.062	3.625	1.062	Spicer	1330/SPL25			N	5-1330X	
3.625	1.062	3.625	1.125	Spicer	1330SPEC			N	5-792X*	5-792X was replaced by 5-7438X; Spicer Life Series
3.625	1.062	3.625	1.125	Spicer	1330SPEC/ SPL25			N	SPL25-3X*	SPL25-3X was replaced by 5-7438X
3.625	1.062	3.625	1.125	Spicer	1330SPEC/ SPL25			N	5-7438X	
3.625	1.062	3.625	1.125	Spicer		1330	1330SPEC	N	5-538X	
3.625	1.062	3.625	1.125	Spicer	1330SPEC			Y	5-1204X	
3.625	1.188	3.625	1.188	Spicer	1350/SPL30			N	SPL30-3X*	2-uncoated, 2-coated bearing caps
3.625	1.188	3.625	1.188	Spicer	1350/SPL30			N	SPL30-4X*	
3.625	1.188	3.625	1.188	Spicer	1350			Y	5-174X	Has metal back seals
3.625	1.188	3.625	1.188	Spicer	1350			Y	5-480X*	5-480X was replaced by 5-178X
3.625	1.188	3.625	1.188	Spicer	1350			Y	5-584X*	5-584X was replaced by 5-178X; same as 5-178X except includes 45° Zerk
3.625	1.188	3.625	1.188	Spicer	1350			Y	5-178X	
3.625	1.188	3.625	1.188	Spicer	1350			Y	15-178X	SVL by Dana
3.625	1.188	3.625	1.188	Spicer	1350			N	5-447X*	5-447X was replaced by 5-3615X; coated bearing caps
3.625	1.188	3.625	1.188	Spicer	1350			N	5-800X*	5-800X was replaced by 5-3615X; coated bearing caps; Spicer Life Series
3.625	1.188	3.625	1.188	Spicer	1350/SPL30			N	SPL30-2X*	SPL30-2X was replaced by 5-3615X; coated bearing caps
3.625	1.188	3.625	1.188	Spicer	1350			N	5-3615X	Coated bearing caps
3.625	1.188	3.625	1.188	Spicer	1350WJ			N	5-282X*	5-282X was replaced by 5-1350X; has metal back seals
3.625	1.188	3.625	1.188	Spicer	1350WJ			N	5-86X*	5-86X was replaced by 5-1350X; used in closed end Spicer front axle; no bearing cap seals

\* Part has been discontinued

† Part is available until supply is exhausted

‡ Not sold separately

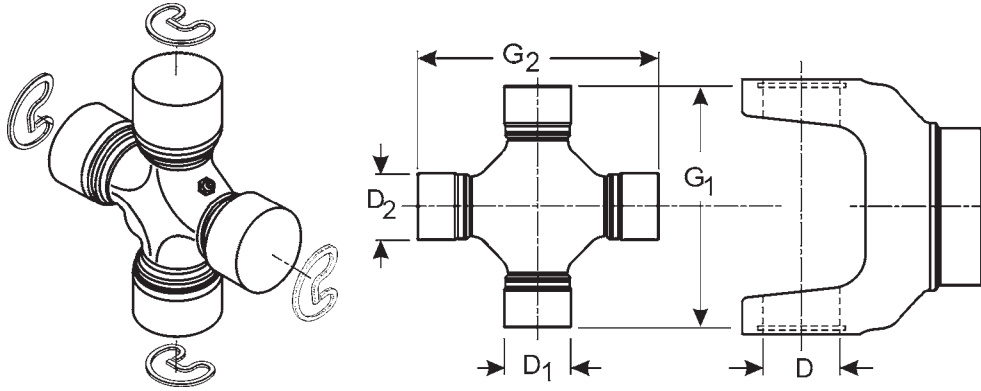

## OUTSIDE SNAP RING (OSR) STYLE (CONTINUED)

G1	D1	G2	D2	OE Manufacturer	OE Series	Converts		Greaseable Y=Yes N=No	Spicer Part #	Notes
Over Caps	Inside Bearing Cap Diameter	Over Caps	Outside Bearing Cap Diameter			From This Series	To This Series Part			
3.625	1.188	3.625	1.188	Spicer	1350			N	5-799X*	5-799X was replaced by 5-1350X; Spicer Life Series
3.625	1.188	3.625	1.188	Spicer	1350/SPL30			N	SPL30-1X*	SPL30-1X was replaced by 5-1350X
3.625	1.188	3.625	1.188	Spicer	1350/SPL30			N	5-1350X	
3.625	1.188	3.625	1.188	Spicer	1350			N	5-471X*	5-471X was replaced by 5-1350-1X; has metal back seals - spec for U.S. government
3.625	1.188	3.625	1.188	Spicer	1350			Y	5-542X*	5-542X was replaced by 5-1350-1X; has metal back seals
3.625	1.188	3.625	1.188	Spicer	1350/SPL30			Y	5-1350-1X	Lube fitting in bearing cap
3.625	1.062	3.625	1.062	Spicer	1330/SPL25			Y	5-1330-1X	
3.625	1.062	3.625	1.062	Spicer	1330/SPL25			Y	5-1330-1X	
3.625	1.062	3.625	1.188	Spicer	1330/1350	1330	1350	Y	5-648X	
3.625	1.125	3.625	1.188	Cleveland	P55	1350	P55	Y	5-1313X*	5-1313X was replaced by 5-3248X
3.625	1.125	3.625	1.188	Spicer	1330SPEC/1350	1330SPEC	1350	Y	5-3248X	
3.693	1.374	3.693	1.374	Bondoli Pavesi	Series 7			Y	5-3238X	
3.767	1.260	3.767	1.260	Spicer Italcardano	96-B			Y	050207000	
3.787	1.066	3.787	1.066	Visteon Special	Staked Replacement			N	5-3203X	
3.900	1.005	3.900	1.005	Borg Warner	3DR			Y	5-265X	4-round knurled caps - no hardware included
4.173	1.374	4.173	1.374	Bondoli Pavesi	Series 8			Y	5-3240X	
4.178	1.375	4.178	1.375	AAM	AAM 1485			N	5-3206X	
4.178	1.188	4.178	1.188	AAM	AAM 1415			N	5-3207X	
4.188	1.188	4.188	1.188	Spicer	1410			N	5-641X*	5-641X was replaced by 5-1410X
4.188	1.188	4.188	1.188	Spicer	1410			Y	5-462X*	5-462X was replaced by 5-1410-1X; has metal back seals
4.188	1.188	4.188	1.188	Spicer	1410			N	5-801X*	5-801X was replaced by 5-1410X; Spicer Life Series
4.188	1.188	4.188	1.188	Spicer	1410/SPL36			N	SPL36-1X*	SPL36-1X was replaced by 5-1410X
4.188	1.188	4.188	1.188	Spicer	1410/SPL36			N	SPL36-3X*	SPL36-3X was replaced by 5-1410X
4.188	1.188	4.188	1.188	Spicer	1410/SPL36			N	5-1410X	
4.188	1.188	4.188	1.188	Spicer	1410/SPL36			N	SPL36-2X*	SPL36-2X was replaced by 5-3616X; coated bearing caps
4.188	1.188	4.188	1.188	Spicer	1410			N	5-3616X	Coated bearing caps; Spicer Life Series
4.188	1.188	4.188	1.188	Spicer	1410/SPL36			N	SPL36-4X*	
4.188	1.188	4.188	1.188	Spicer	1410			N	5-429X*	Has metal back seals
4.188	1.188	4.188	1.188	Spicer	1410			Y	5-481X*	5-481X was replaced by 5-160X
4.188	1.188	4.188	1.188	Spicer	1410			Y	5-160X	
4.188	1.375	4.188	1.375	Spicer	1480/SPL55			N	SPL55-2X*	
4.188	1.375	4.188	1.375	Spicer	1480			Y	5-263X*	5-263X was replaced by 5-188X

\* Part has been discontinued

† Part is available until supply is exhausted

‡ Not sold separately

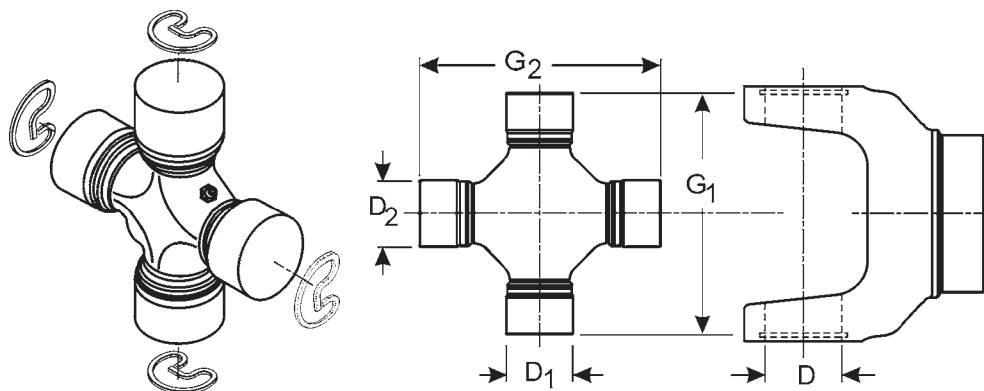

## OUTSIDE SNAP RING (OSR) STYLE (CONTINUED)

G1	D1	G2	D2	OE Manufacturer	OE Series	Converts		Greasable	Spicer Part #	Notes
Over Caps	Inside Bearing Cap Diameter	Over Caps	Outside Bearing Cap Diameter			From This Series	To This Series Part	Y=Yes N=No		
4.188	1.375	4.188	1.375	Spicer	1480			Y	5-482X*	5-482X was replaced by 5-188X
4.188	1.375	4.188	1.375	Spicer	1480			Y	5-188X	
4.188	1.375	4.188	1.375	Spicer	1480			N	5-803X*	5-803X was replaced by SPL55X; Spicer Life Series
4.188	1.375	4.188	1.375	Spicer	1480/SPL55			N	SPL55X	
4.188	1.375	4.188	1.375	Spicer	1480			N	5-319X*	5-319X was replaced by SPL55-1X; has metal back seals
4.188	1.375	4.188	1.375	Spicer	SPL55/1480			Y	5-804X*	5-804X was replaced by SPL55-1X; Spicer Life Series
4.188	1.375	4.188	1.375	Spicer	1480/SPL55			Y	SPL55-1X	
4.188	1.188	4.188	1.188	Cleveland	O55			Y	5-1206X*	5-1206X was replaced by 5004989
4.188	1.188	4.188	1.188	Cleveland	SPL36/O55			N	5004989	
4.188	1.188	4.188	1.188	Spicer	1410/SPL36			Y	5-1410-1X	Lube fitting in bearing cap
4.188	1.375	4.188	1.375	Walterscheid	2200			Y	044439*	
4.232	1.614	4.232	1.614	Bondoli Pavesi	Series 7			Y	5-3239X	
4.312	1.531	4.312	1.531	Rockwell	55N			Y	5-432X*	5-432X was replaced by 5-3225X
4.307	1.533	4.307	1.533	Rockwell	55N			Y	5-3225X	
4.946	1.375	4.946	1.375	AAM	AAM 1555			N	5-3230X	
4.957	1.625	4.957	1.625	Spicer	SPL90			Y	SPL90X*	SPL90X was replaced by SPL100-1X
4.957	1.625	4.957	1.625	Spicer	SPL100			Y	SPL100-1X	Dimensionally same as SPL90X
4.964	1.375	4.964	1.375	Spicer	1550			Y	5-304X*	5-304X was replaced by 5-155X; OEM kit
4.964	1.375	4.964	1.375	Spicer	1550			Y	5-483X*	5-483X was replaced by 5-155X
4.964	1.375	4.964	1.375	Spicer	1550			Y	5-543X*	5-543X was replaced by 5-155X; has metal back seals
4.964	1.375	4.964	1.375	Spicer	1550			Y	5-155X	
4.964	1.375	4.964	1.375	Spicer	1550			Y	5-546X*	2 snap rings and 2 thrust plates w/ metric bolts
4.964	1.375	4.964	1.375	Spicer	1550			N	5-808X*	5-808X was replaced by SPL70X; Spicer Life Series
4.964	1.375	4.964	1.375	Spicer	1550/SPL70			N	SPL70X	
4.964	1.375	4.964	1.375	Spicer	1550			Y	5-275X†	5-275X will be replaced by SPL70-1X when supply is exhausted; has metal back seals
4.964	1.375	4.964	1.375	Spicer	1550			Y	5-778X*	5-778X was replaced by SPL70-1X; same as 5-275X but has 45° Zerk and metal back seals
4.964	1.375	4.964	1.375	Spicer	1550/SPL70			Y	SPL70-1X	
5.590	1.623	5.590	1.623	Spicer	1650			Y	5-165X	
6.011	1.980	6.011	1.980	Spicer Italcardano				Y	050967100	Has 3-hole plates instead of snap rings
6.772	2.559	6.772	2.559	Spicer	SPL350			Y	SPL350X	
6.772	2.559	6.772	2.559	Spicer	SPL350			N	SPL350SFX	
8.092	2.186	8.092	2.186	Spicer	1850			Y	5-185X*	

\* Part has been discontinued

† Part is available until supply is exhausted

‡ Not sold separately

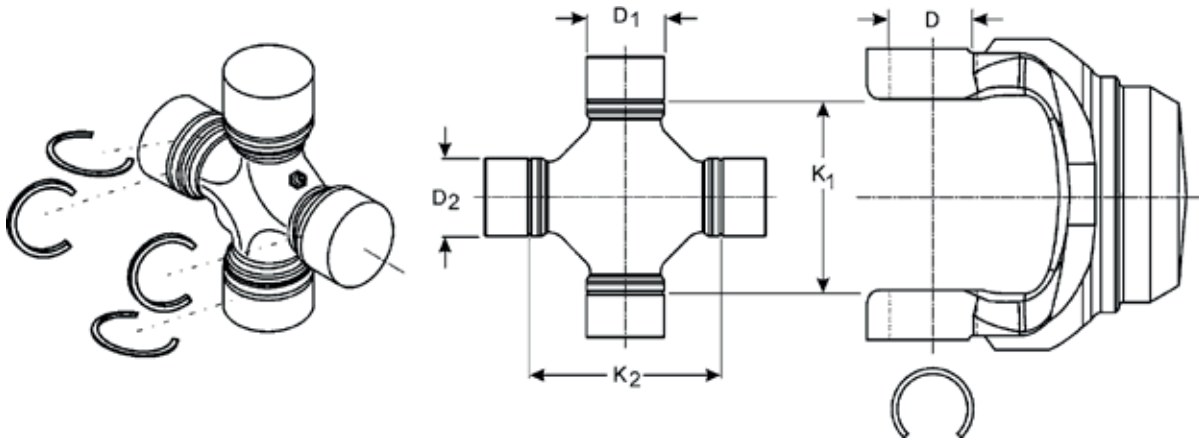

## INSIDE SNAP RING (ISR) STYLE

K1	D1	K2	D2	OE Manufacturer	OE Series	Converts		Greasable	Spicer Part #	Notes
Between Snap Rings	Inside Bearing Cap Diameter	Between Snap Rings	Outside Bearing Cap Diameter			From This Series	To This Series Part	Y=Yes N=No		
1.400	0.867	1.400	0.867	Toyota/Nissan	Staked Replacement			Y	5-3202X	Lube fitting in bearing cap
1.445	0.971	1.445	0.971	Rockwell	L6N			Y	5-92X	
1.482	0.886	1.482	0.886	Mazda				N	5-1514X	
1.496	0.787	1.496	0.787	Datsun-Toyota				N	5-1500X	
1.500	0.938	1.445	0.971	Rockwell	L6N	1000	L6N	Y	5-430X	
1.500	0.938	1.500	0.938	Spicer	1000			N	5-110X	
1.500	0.938	1.500	0.938	Spicer	1000SG			Y	5-755X*	Used in aluminum steering shafts
1.500	0.938	1.500	0.938	Spicer	1000			Y	5-170X	Used in PTO shafts
1.500	0.938	1.500	0.938	Spicer	1000			Y	5-170-1X	Lube fitting in bearing cap
1.500	0.938	1.500	0.938	Spicer	1000SG			Y	5-103X	Used in steel steering shafts
1.640	1.062	1.640	1.062	Spicer	1210WJ			N	5-456X*	5-456X was replaced by 5-3215X
1.629	1.062	1.629	1.062	Spicer	1210WJ			N	5-3215X	
1.718	1.000	1.718	1.000	Spicer	1100			Y	5-105X	
1.721	0.984	1.721	0.984	Mazda				Y	5-3229X	
1.723	0.984	1.723	0.984	Mazda				N	5-1504X*	
1.734	0.984	1.734	0.984	Datsun				N	5-1501X	
1.828	1.062	1.828	1.062	Rockwell	L12N	1140	L12N	Y	5-242X	
1.830	1.126	1.830	1.126		Howes 14			Y	5-3265X	
1.843	1.024	1.843	1.024	Toyota				Y	5-3223X	
1.900	0.947	1.900	0.947	BMW/Mazda	Staked Replacement			Y	5-3201X	Lube fitting in bearing cap
1.923	1.062	1.923	1.062		Nissan/Infiniti			Y	5-3218X	
1.980	1.044	1.980	1.044		Kia/Mazda			Y	5-3245-1X	
2.000	1.228	2.000	1.228	Detroit	5160			Y	5-3251X	
2.047	1.142	2.047	1.142	Toyota				Y	5-1510X	
2.080	1.142	2.080	1.142	Chev Luv				Y	5-1515X	
2.118	1.125	2.118	1.125		Mechanics 2.5			Y	5-3219-1X	
2.120	1.079	2.120	1.079	Detroit	7260			Y	5-3228X	
2.125	1.078	2.125	1.078	Detroit	7260			Y	5-1306X*	5-1306X was replaced by 5-789X
2.125	1.078	2.125	1.078	Detroit	7260			Y	5-1306-1X*	5-1306-1X was replaced by 5-789X; lube fitting in bearing cap
2.125	1.078	2.125	1.078	Detroit	7260			N	SPL22-8X*	SPL22-8X was replaced by 5-789X
2.125	1.078	2.125	1.078	Detroit	7260			N	5-789X	Spicer Life Series
2.125	1.078	2.125	1.078	Mercuriser	7260			Y	5-589X*	Mercuriser kit
2.125	1.078	2.625	1.125	Detroit	7260	7260	7290	Y	5-527X*	5-527X was replaced by 5-3244X
2.125	1.078	2.625	1.125	Detroit		7290	7260	Y	5-3244X	
2.140	1.251	2.140	1.251		Howse 15			Y	5-3266X	

\* Part has been discontinued

† Part is available until supply is exhausted

‡ Not sold separately



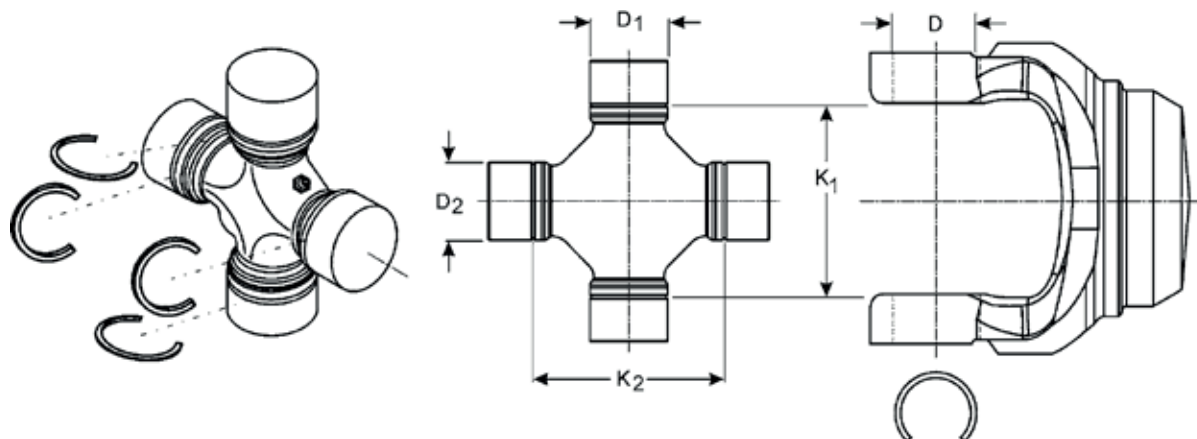

## INSIDE SNAP RING (ISR) STYLE (CONTINUED)

K1 Between Snap Rings	D1 Inside Bearing Cap Diameter	K2 Between Snap Rings	D2 Outside Bearing Cap Diameter	OE Manufacturer	OE Series	Converts		Greaseable Y=Yes N=No	Spicer Part #	Notes
						From This Series	To This Series Part			
2.188	1.062	2.188	1.062	Spicer	1310WJ			N	5-74X*	5-74X was replaced by 5-260X; used in closed end; Spicer front axle
2.188	1.062	2.188	1.062	Spicer	1310WJ			Y	5-260-1X*	5-260-1X was replaced by 5-260X; lube fitting in bearing cap
2.188	1.062	2.188	1.062	Spicer	1310WJ			N	5-260X	
2.188	1.188	2.188	1.188	Spicer	1310WJ			Y	5-297-1X*	5-297-1X was replaced by 5-3226X; lube fitting in bearing cap
2.188	1.188	2.188	1.188	Spicer	1310WJ			Y	5-3226X	
2.188	1.188	2.188	1.188	Spicer	1310WJ			N	5-297X*	5-297X was replaced by 5-760X
2.188	1.188	2.188	1.188	Spicer	1310WJ			N	5-760X	
2.200	1.025	2.200	1.025	Toyota				Y	5-1508X	
2.208	1.102	2.208	1.102	Datsun				Y	5-1505X	
2.282	1.181	2.282	1.181		Mitsubishi			Y	5-3243X	
2.288	1.188	2.288	1.188	Spicer	SPL30			N	5004891*	5004891 was replaced by 5-7166X
2.406	1.188	2.406	1.188	Spicer	1350WJ			N	5-7166X	
2.315	1.102	2.315	1.102					Y	5-3216X	
2.337	1.000	2.337	1.000	Mechanics	2RL			Y	5-3263X	
2.337	1.000	2.337	1.000		Mechanics 2			Y	5-3242X	
2.343	1.062	2.343	1.062	Spicer	1310			Y	5-350X*	5-350X was replaced by 5-3254X
2.344	1.000	2.344	1.000	Mechanics	2R			Y	5-2011X*	5-2011X was replaced by 5-3242X
2.340	1.062	2.340	1.062	Spicer	1310			Y	5-3254X	
2.375	1.062	2.375	1.062	Cleveland	S55			Y	5-718X*	Coated bearing caps
2.375	1.062	2.375	1.062	Cleveland	S55			Y	5-1200X	
2.453	1.497	2.453	1.497	Mercedes				Y	5-1506X*	
2.520	1.260	2.520	1.260	Toyota				Y	5-1511X*	5-1511X was replaced by 5-3221X
2.520	1.260	2.520	1.260	Toyota				Y	5-3221X	
2.556	1.125	2.556	1.125	Mechanics	S44			Y	5-3147X	
2.556	1.125	2.556	1.125	Mechanics	S44			N	SPL25-6X*	SPL25-6X was replaced by 5-795X
2.556	1.125	2.556	1.125	Spicer	SPL25/S44			N	5-795X	Spicer Life Series

\* Part has been discontinued

† Part is available until supply is exhausted

‡ Not sold separately

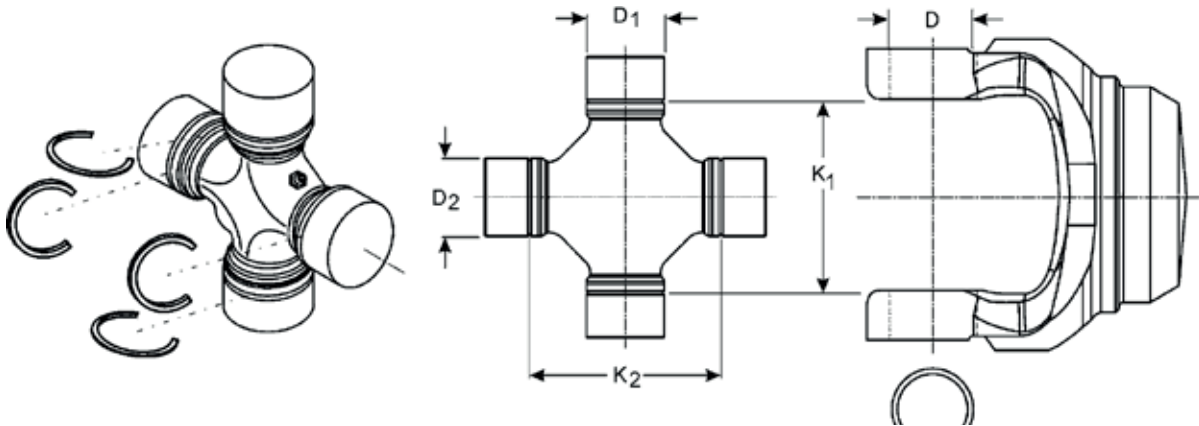

## INSIDE SNAP RING (ISR) STYLE (CONTINUED)

K1	D1	K2	D2	OE Manufacturer	OE Series	Converts		Greasable	Spicer Part #	Notes
Between Snap Rings	Inside Bearing Cap Diameter	Between Snap Rings	Outside Bearing Cap Diameter			From This Series	To This Series Part	Y=Yes N=No		
2.563	1.188	2.563	1.188	Cleveland	R55			Y	5-1205X*	5-1205X was replaced by 5-3250X
2.587	1.125	2.587	1.125		AAM 1344			N	5-3211X	
2.625	1.125	2.625	1.125	Detroit	7290			N	SPL25-9X*	SPL25-9X was replaced by 5-811X
2.625	1.125	2.625	1.125	Detroit	7290			N	5-811X	Spicer Life Series
2.625	1.125	2.625	1.125	Detroit	7290			Y	5-1309X	
2.635	1.125	2.556	1.125	Detroit/ Mechanics	7290/S44	7290	S44	N	5-3163X*	
2.781	1.312	2.781	1.312	Rockwell	44R			Y	5-431X	
2.798	1.062	2.798	1.062	Spicer	1330			Y	5-1203X	
2.831	1.142	2.831	1.142		Acura/Isuzu			Y	5-3259-1X	
2.920	1.375	2.920	1.375	AAM	1485WJ			N	5006813	Spicer Life Series
2.954	1.375	2.954	1.375	AAM	1485S			N	5-3231X	
3.000	1.231	3.000	1.231	Detroit	5380			Y	5-1301X	
3.000	1.375	3.000	1.375	Spicer	1480WJ			N	5-88X*	5-88X was replaced by SPL55-3X; used in closed end; Spicer front axle
3.000	1.375	3.000	1.375	Spicer	SPL55/ 1480WJ			N	5-806X*	5-806X was replaced by SPL55-3X; wheel joint
3.000	1.375	3.000	1.375	Spicer	1480WJ			N	5-332X*	5-332X was replaced by SPL55-3X; can use 5-806X
3.000	1.375	3.000	1.375	Spicer	SPL55/ 1480WJ			N	SPL55-3X	Wheel joint; same as 5-806X
3.000	1.375	3.000	1.375	Spicer	SPL55/ 1480WJ			Y	5-807X*	5-807X was replaced by SPL55-4X; wheel joint
3.000	1.375	3.000	1.375	Spicer	SPL55/ 1480WJ			Y	SPL55-4X	Wheel joint; same as 5-807X
3.125	1.188	3.125	1.188	Cleveland	O55			Y	5-1206X*	5-1206X was replaced by 5004989
3.125	1.188	3.125	1.188	Spicer	SPL36/O55			N	5004989	Includes 4 inside and 4 outside snap rings
3.250	1.125	3.250	1.125	Mechanics	4R			Y	5-4015X*	
3.737	1.375	3.737	1.375	AAM	AAM 155			N	5-3212X	
3.780	1.375	3.780	1.375	Spicer	SPL70WJ			N	SPL70-3X*	SPL70-3X was replaced by SPL70-4X
3.780	1.375	3.780	1.375	Spicer	SPL70WJ			Y	SPL70-4X	

\* Part has been discontinued

† Part is available until supply is exhausted

‡ Not sold separately



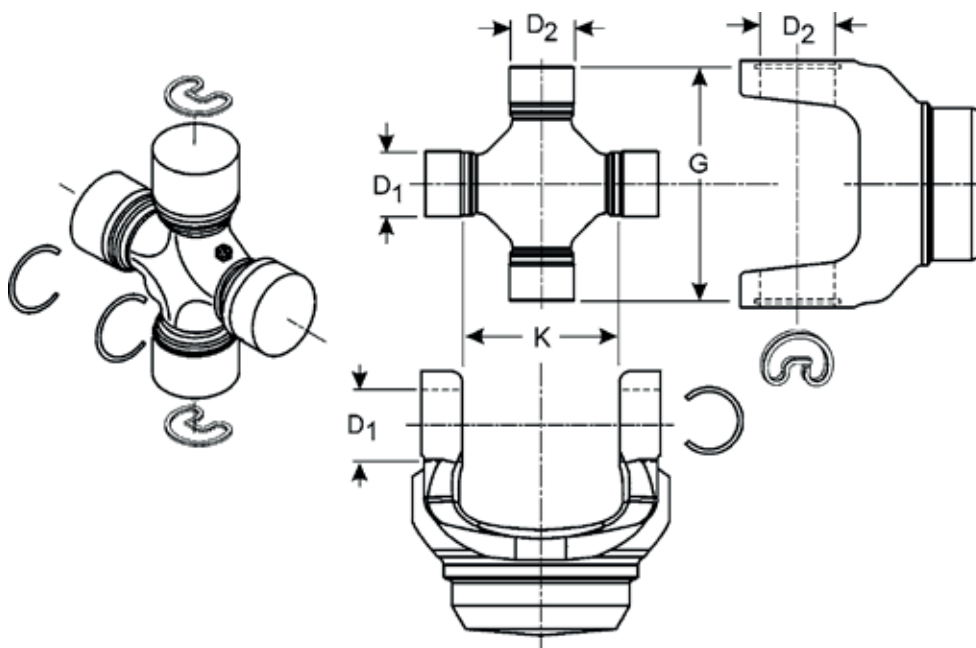

## OUTSIDE SNAP RING/INSIDE SNAP RING (OSR/ISR) STYLE

K	D1	G	D2	OE Manufacturer	OE Series	Converts		Greaseable Y=Yes N=No	Spicer Part #	Notes
Inside Snap Ring Dimension	Inside Bearing Cap Diameter	Outside Snap Ring Dimension	Outside Bearing Cap Diameter			From This Series	To This Series Part			
1.629	1.062	2.456	1.062	Spicer	1210WJ			N	5-3215X	
1.719	1.000	2.438	1.062	Spicer	1110SPEC			Y	5-249X*	5-249X was replaced by 5-248X
1.719	1.000	2.438	1.062	Spicer	1110/1210	1110	1210	Y	5-248X	Grease Zerk in center of cross
2.049	1.142	3.219	1.062	Toyota		Toyota	1310	Y	5-721X*	
2.125	1.078	3.219	1.062	Detroit	7260	7260	1310	Y	5-353X*	5-353X was replaced by 5-788X
2.125	1.078	3.219	1.062	Detroit	7260	7260	1310	N	5-634X*	5-634X was replaced by 5-788X
2.125	1.078	3.220	1.062	Detroit	7260	7260	1310/ SPL22	N	SPL22-4X*	SPL22-4X was replaced by 5-788X
2.125	1.078	3.219	1.062	Detroit	7260	7260	1310	N	5-788X	Spicer Life Series
2.125	1.078	3.219	1.062	Detroit	7260	7260	1310	N	5-647X*	Coated bearing caps
2.125	1.078	3.625	1.062	Detroit	7260	7260	1330	Y	5-599X*	5-599X was replaced by 5-3246X
2.116	1.078	3.625	1.062	Spicer	1330/7290	7290	1330	Y	5-3246X	
2.125	1.125	3.219	1.062	Mechanics		2.5R	1310	N	5-2530X*	5-2530X was replaced by 5-3247X; plug in center of cross; lube fitting not included
2.125	1.125	3.219	1.062	Mechanics		2.5R	1310	Y	5-3247X	Plug in center of cross; lube fitting not included
2.181	1.062	3.219	1.062	Spicer	SPEC			Y	5-3249X	
2.324	1.062	3.219	1.062		1310SPEC			Y	5-3213X	
2.344	1.000	3.219	1.062	Spicer		2R	1310	Y	5-2140X	
2.344	1.000	3.219	1.125	Mechanics	2CL	2CL	1260	Y	5-2173X	
2.375	1.062	3.625	1.062	Cleveland	S55			Y	5-1202X*	
2.556	1.125	3.219	1.062	Mechanics	S44	S44	1310	Y	5-3022X*	5-3022X was replaced by 5-3022-1X
2.556	1.125	3.219	1.062	Mechanics	S44	S44	1310	Y	5-3022-1X	
2.556	1.125	3.625	1.062	Spicer	1330/S44			N	5-541X*	5-541X was replaced by 5-793X
2.556	1.125	3.625	1.062	Mechanics	S44	S44	1330	N	5-619X*	5-619X was replaced by 5-793X
2.556	1.125	3.625	1.062	Mechanics	S44	S44	1330	N	5-621X*	5-621X was replaced by 5-793X
2.556	1.125	3.625	1.062	Mechanics	S44	S44	1330	N	5-794X*	5-794X was replaced by 5-793X; outside snap ring caps are coated; Spicer Life Series
2.556	1.125	3.625	1.062	Mechanics	S44	S44	1330/ SPL25	N	5-7436X*	5-7436X was replaced by 5-793X
2.556	1.125	3.625	1.062				1330	N	5003097†	5003097 will be replaced by 5-793X when supply is exhausted
2.556	1.125	3.625	1.062	Mechanics	S44	S44	1330/ SPL25	N	SPL25-4X*	SPL25-4X was replaced by 5-793X

\* Part has been discontinued

† Part is available until supply is exhausted

‡ Not sold separately

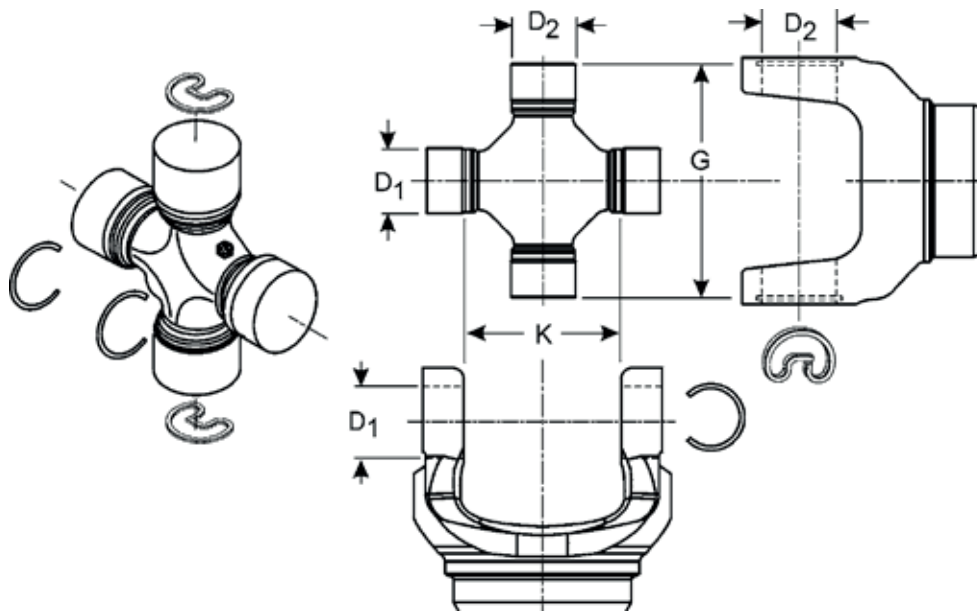

## OUTSIDE SNAP RING/INSIDE SNAP RING (OSR/ISR) STYLE (CONTINUED)

K	D1	G	D2	OE Manufacturer	OE Series	Converts		Greasable	Spicer Part #	Notes
Inside Snap Ring Dimension	Inside Bearing Cap Diameter	Outside Snap Ring Dimension	Outside Bearing Cap Diameter			From This Series	To This Series Part	Y=Yes N=No		
2.556	1.125	3.625	1.062	Mechanics	S44	S44	1330/ SPL25	N	SPL25-5X*	SPL25-5X was replaced by 5-793X; outside snap ring caps are coated Spicer Life Series
2.556	1.125	3.625	1.062	Spicer	1330/S44			N	5-793X	
2.556	1.125	3.625	1.062	Mechanics	S44	S44	1330	Y	5-212X	
2.556	1.125	3.625	1.125	Cleveland	P55	S44	P55	Y	5-1312X*	5-1312X was replaced by 5-3255X
2.556	1.125	3.625	1.125	Cleveland	P55-55-675			Y	5-3255X	
2.556	1.125	3.625	1.188	Mechanics	1350/S44	S44	1350	Y	5-3205X	
2.563	1.188	3.625	1.188	Cleveland	R55			Y	5-3250X	
2.625	1.125	3.219	1.062	Detroit		7290	1310	Y	5-354X*	5-354X was replaced by 5-3222X
2.613	1.126	3.219	1.062	Spicer			1310	Y	5-3222X	
2.625	1.125	3.625	1.062	Detroit	7290	7290	1330	N	5-637X*	5-637X was replaced by 5-7437X
2.625	1.125	3.625	1.062	Detroit	7290	7290	1330	N	5-672X*	5-672X was replaced by 5-7437X
2.625	1.125	3.625	1.062	Detroit	7290	7290	1330	N	5-796X*	5-796X was replaced by 5-7437X; Spicer Life Series
2.625	1.125	3.625	1.062	Detroit	7290	7290	1330/ SPL25	N	SPL25-7X*	SPL25-7X was replaced by 5-7437X
2.625	1.125	3.625	1.062	Detroit	7290	7290	1330/ SPL25	N	SPL25-8X*	SPL25-8X was replaced by 5-7437X; coated bearing caps
2.625	1.125	3.625	1.062	Detroit	7290/1330	7290	1330/ SPL25	N	5-7437X	
2.625	1.125	1.062		Detroit	7290	7290	1330	Y	5-3227X	
2.767	1.062	3.625	1.125	Spicer		1330	1330SPEC	N	5-538X*	5-538X was replaced by 5-1204X
2.767	1.062	3.625	1.125	Spicer	1330SPEC				5-1204X	
2.767	1.062	3.625	1.125	Spicer	1330SPEC				15-1204X	
2.767	1.125	3.625	1.188	Cleveland	P55	1350	P55	Y	5-1313X*	5-1313X was replaced by 5-3248X
2.798	1.062	3.625	1.062	Spicer	1330			Y	5-1203X	
3.000	1.231	4.188	1.188	Detroit	5380	5380	1410	Y	5-357X	
3.125	1.188	4.188	1.188	Cleveland	O55			Y	5-1206X*	5-1206X was replaced by 5004989
3.125	1.188	4.188	1.188	Cleveland	SPL36/O55			N	5004989	

\* Part has been discontinued

† Part is available until supply is exhausted

‡ Not sold separately